

Department of Civil Engineering and Engineering Mechanics
Columbia University



Structure & Architecture - Teamwork at the University of Kassel

by **Werner Seim, Brigitte Haentsch, Tina Wallbaum**

University of Kassel

Host: Prof. C. Meyer

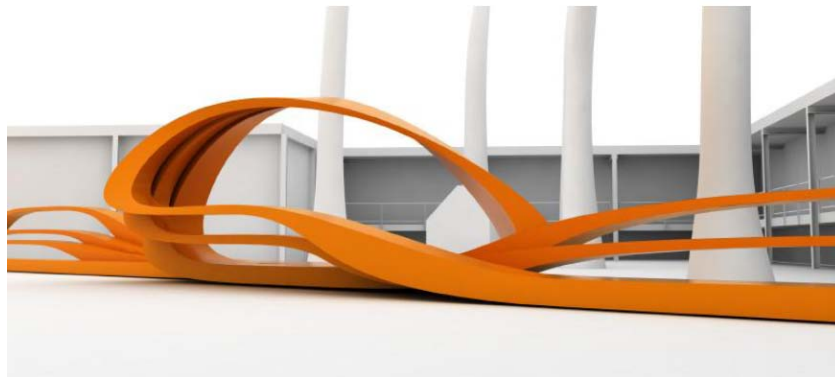

At the University of Kassel there is a good tradition for cooperation between the departments of architecture and civil engineering. Two projects where student teams from both faculties worked closely together will be presented: The 18th century malthouse is an important part of the monastery complex of Ossek (Northern Bohemia, Czechia). Based on the assessment and analysis of the existing structure rehabilitation and post-strengthening measures were developed. A new use of the building to host exhibitions was suggested. A second project focused on computer aided manufacturing technologies, which were used to develop and manufacture new types of timber structures. An important part of the project was the design of new types of connections. Two more projects should represent the involvement of the structural engineering in the design process of the architecture studios. It shows the important role of the consulting between the two professions.

September 15, 2009 (Tuesday)

2:30 - 4:00 p.m.

Room 644, Mudd

<http://www.civil.columbia.edu/~ling/seminar>